

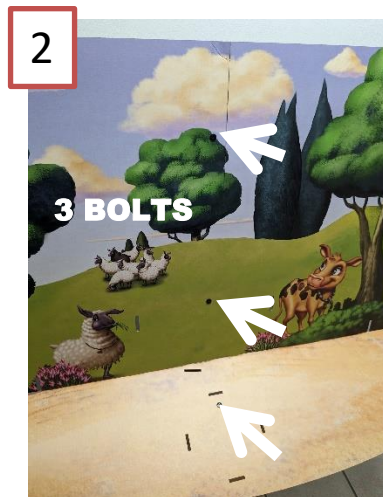

Set up the **EASEL** by folding each side back 90° and locking in place with the lower flap. Overlap the two upper panels so that the lock tab pokes through the slot.

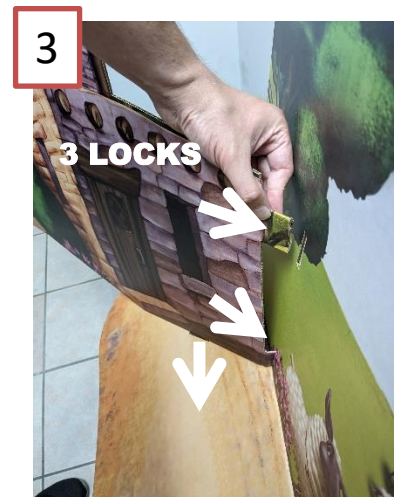

Attach the **BACKDROP** to the **EASEL** with 3 bolts. Two bolts on the upper section, and one on the lower that sits at an angle.



Connect either of the left or right **BUILDINGS** by folding over the 3 wing-locks and inserting into the slots on the left/right side of the **BACKDROP**.



Fold the **BUILDING** to wrap it around the back edge of the display. Connect with 1 bolt to the **BACKDROP**. Repeat steps 3 & 4 for the building on the opposite side.

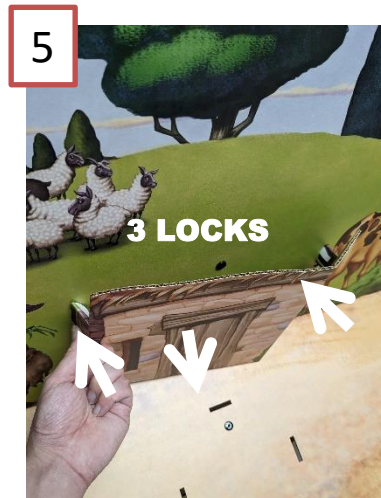

Connect the **MIDDLE BUILDING** by pressing the center lock tab down into the base, then folding the 2 wing-locks on each side and inserting into the back.



Begin assembling the **WELL** by folding all sides into a circle. Connect the flap on the rear with a single bolt.



Lay the round top of the **WELL** over the brick section. Fold down the small tabs and align the slots on the left and right side.



Fold the wing-locks of the vertical **SUPPORTS** and insert through the slots in the **WELL**. These will connect the upper and lower sections.



Press the **WELL** into the base of the **BACKDROP** by aligning the 4 lock tabs and pushing down. Make sure it is level, with the tall side facing forward.



Place the horizontal well crank **HANDLE** on top of the vertical **SUPPORTS**. Let it rest on top after aligning the small slots.



Attach the Hometown Nazareth **SIGN** by aligning the 2 slots in the **BACKDROP** and pressing down until it's all the way down.



The finished Hometown Nazareth display should look like this.